



# ARIES

VARH · Gelatto display counter

# CORAL

VCB · Gelatto display counter



Two different designs, with straight and curved glass, to integrate into all sales areas.



Freezing design with two completely independent circuits. The first prevents frost accumulation on the ice cream and the second produces a temperature drop with uniform temperatures.



Tested under demanding environmental conditions to provide the best performance in all environmental conditions.



Display counter for the sale of icecream in traditional assisted service.

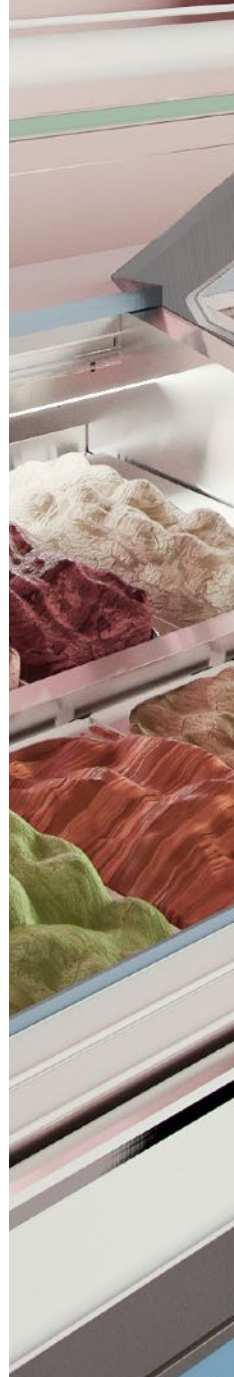



 Infrico

# ARIES SERIES

Gelatto display counter  
VARH



PLUG IN

GELATTO

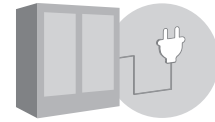

## AVAILABLE MODELS

VAR12H

VAR15H

VAR18H

**ELECTRICAL DATA:** 220 V / 1Ph / 60 Hz

**REFRIGERANT CONNECTION:** R-290

**PRODUCT TEMP:** 0°F / 5°F

## GENERAL DATA

MODEL	VAR12H	VAR15H	VAR18H
LENGTH (in)	41 1/5	61 1/2	73 5/6
TOTAL VOLUME (ft³)	6 3/7	8	9 2/3
TDA (ft²)	9 1/7	11 2/5	13 2/3

## GENERAL DATA

MEASURE (in)	45 x 51 1/2 x **L (in)
SHELVES (in)	—
N° SHELVES	—
EXPOSITION DECK (in)	—
SIDE PANEL THICKNESS (in)	1 1/6

## STANDAR FEATURES

### Exterior:

- Laminated sheet.
- Worktop in compac Quartz White
- Sides and decoration in water-resistand MDF

### Interior:

- AISI 304 Stainless Steel.
- Low consumption LED Lighting
- Rear nighth curtain

### Insulation:

- CFC-Free polyurethane insulation, entire cabinet structure is foamed-in place using a high density polyurethane insulation.

### Electrical and electronic controllers:

- Remote alarm signals.
- Encapsulated and sealed NTC temperature probes.
- Effective way to visualize temperature.
- Cord and NEMA 6-20P plug. Electrical connections is 220V/ 1ph/ 60 Hz

### Refrigeration:

- Digital temperature controller with automatic defrost system.

## OPTIONAL EQUIPMENT

- Tray combination (14 1/6 x 6 1/2 x 6)
- Tray combination (14 1/6 x 9 5/6 x 3 1/7)

SECCION VAR H+ UL

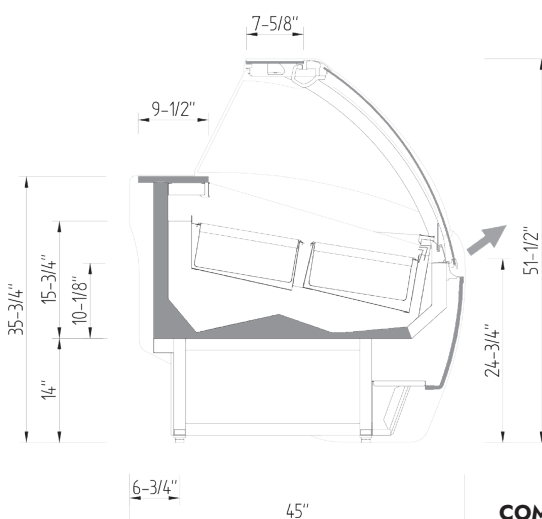

COMMERCIAL SECTION

# CORAL SERIES

## Gelatto display counter

### VCBUH



PLUG IN

GELATTO

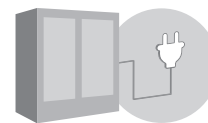

### AVAILABLE MODELS

VCB12UH

VCB15UH

VCB18UH

**ELECTRICAL DATA:** 220 V / 1Ph / 60 Hz

**REFRIGERANT CONNECTION:** R-290

**PRODUCT TEMP:** 0°F / 5°F

### GENERAL DATA

MODEL	VCB12UH	VCB15UH	VCB18UH
LENGTH (in)	49 1/5	61 1/2	73 5/6
TOTAL VOLUME (ft³)	6 3/7	8	9 2/3
TDA (ft²)	9 1/7	11 2/5	13 2/3

### GENERAL DATA

MEASURE (in)	41 3/8 x 47 3/16 x **L (in)
SHELVES (in)	—
N° SHELVES	—
EXPOSITION DECK (in)	—
SIDE PANEL THICKNESS (in)	4/5

### STANDAR FEATURES

#### Exterior:

- Laminated sheet.
- Worktop in compac Quartz White
- Sides and decoration in water-resistand MDF

#### Interior:

- AISI 304 Stainless Steel.
- Low consumption LED Lighting
- Rear nighth curtain

#### Insulation:

- CFC-Free polyurethane insulation, entire cabinet structure is foamed-in place using a high density polyurethane insulation.

#### Electrical and electronic controllers:

- Remote alarm signals.
- Encapsulated and sealed NTC temperature probes.
- Effective way to visualize temperature.
- Cord and NEMA 6-20P plug. Electrical connections is 220V/ 1ph/ 60 Hz

#### Refrigeration:

- Digital temperature controller with automatic defrost system.

### OPTIONAL EQUIPMENT

- Tray combination (14 1/6 x 6 1/2 x 6)
- Tray combination (14 1/6 x 9 5/6 x 3 1/7))

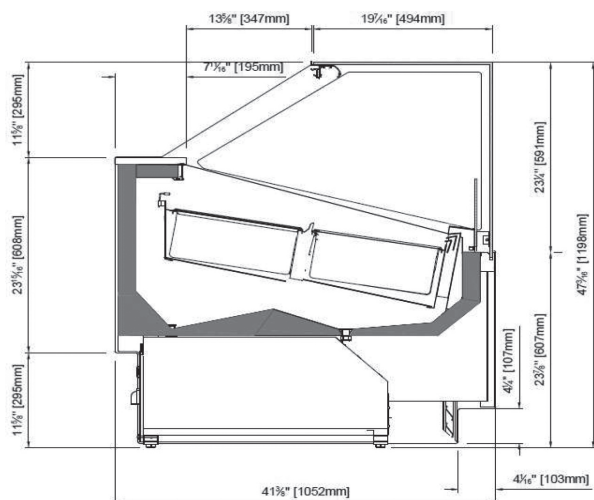

COMMERCIAL SECTION