



EDINBURGH

SMDG · SMPB · Remote refrigeration open and closed low multidecks



EXCELLENCE IN THE SHOPPING EXPERIENCE

Sliding doors with soft closing as standard Wide range of options, end panels and customization possibilities.



OPTIMIZED PRODUCT SIZES FOR MAXIMUM CAPACITY WITH A SMALLER FOOTPRINT

Width 35 3/7, height 59 (in) and lengths from 49 1/5 to 147 2/3 (in).



FULL VISIBILITY OF THE DISPLAY PRODUCTS

Fully transparent double glass doors or display front on open models High efficiency LED lighting.



PREPARED TO DISPLAY ALL TYPES OF REFRIGERATED PRODUCTS



EDINBURGH SERIES

Remote refrigeration open and closed low multidecks
SMLDG



REMOTE

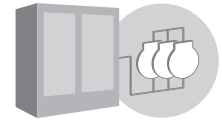

FOR



AVAILABLE MODELS

SML12DGM1	SML18DGM1	SML25DGM1
SML37DGM1		

ELECTRICAL DATA: 115 V / 1Ph / 60 Hz

REFRIGERANT CONNECTION: Freon, CO2

PRODUCT TEMP: 33°F / 41°F

GENERAL DATA

MODEL	SML12DGM1	SML18DGM1	SML25DGM1	SML37DGM1
LENGTH (in)	49 1/5	73 5/6	98 3/7	147 2/3
TOTAL VOLUME (ft³)	17 1/16	25 3/4	34 1/3	51 1/2
TDA (ft²)	16	24	32	48

GENERAL DATA

MEASURE (in)	35 9/16 x 59 1/16 x **L (in)
SHELVES (in)	11 13/16 · 13 3/4 · 15 3/4
N° SHELVES	3
EXPOSITION DECK (in)	23 5/8
SIDE PANEL THICKNESS (in)	1 4/7

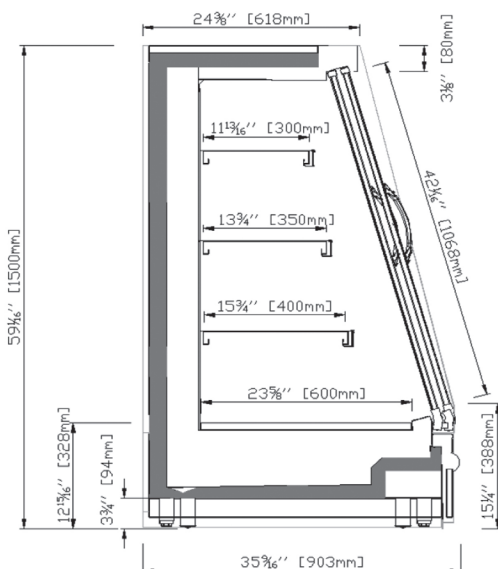

COMMERCIAL SECTION

STANDAR FEATURES

Exterior:

- Full size double panel glass doors that prevent heat transmission
- Epoxy painted steel sheet
- Double panel glass sides

Interior:

- AISI 304 Stainless Steel.
- Stainless Steel internal panel perforated.
- Height and incline adjustable stainlees steel shelves

Insulation:

- CFC-Free polyurethane insulation, entire cabinet structure is foamed-in place using a high density polyurethane insulation.

Electrical and electronic controllers:

- Remote alarm signals.
- Encapsulated and sealed NTC temperature probes.
- Effective way to visualize temperature.

Refrigeration:

- Digital temperature controller with automatic defrost system.

EDINBURGH SERIES

Remote refrigeration open and closed low multidecks

SMLPB



REMOTE

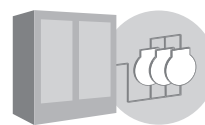

AVAILABLE MODELS

SML12PBM1	SML18PBM1	SML25PBM1
SML37PBM1		

ELECTRICAL DATA: 115 V / 1Ph / 60 Hz

REFRIGERANT CONNECTION: Freon, CO2

PRODUCT TEMP: 33°F / 41°F

GENERAL DATA

MODEL	SML12PBM1	SML18PBM1	SML25PBM1	SML37PBM1
LENGTH (in)	49 1/5	73 5/6	98 3/7	147 2/3
TOTAL VOLUME (ft³)	17 1/6	25 3/4	34 1/3	51 1/2
TDA (ft²)	16	24	32	48

GENERAL DATA

MEASURE (in)	35 5/8 x 59 x **L (in)
SHELVES (in)	11 1/2 · 13 1/2 · 17 1/2
N° SHELVES	3
EXPOSITION DECK (in)	23 1/2
SIDE PANEL THICKNESS (in)	1 4/7

STANDAR FEATURES

Exterior:

- Epoxy painted steel sheet
- Double panel glass sides
- Adjustable feet

Interior:

- AISI 304 Stainless Steel.
- Stainless Steel internal panel perforated.
- Height and incline adjustable stainless steel shelves

Insulation:

- CFC-Free polyurethane insulation, entire cabinet structure is foamed-in place using a high density polyurethane insulation.

Electrical and electronic controllers:

- Remote alarm signals.
- Encapsulated and sealed NTC temperature probes.
- Effective way to visualize temperature

Refrigeration:

- Digital temperature controller with automatic defrost system.

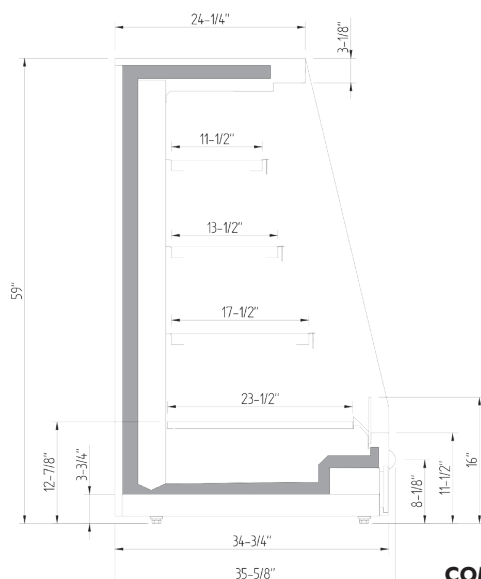

COMMERCIAL SECTION